

# THE GREENING OF NORMERICA ... a Tradition since 1979.

Every Normerica timber frame home is enveloped with an energy-efficient roof and wall system ensuring a healthy and environmentally friendly home.

*"As far back as the early 1980's, we developed the building science behind our roof and wall system to meet the energy efficient standards of the R-2000 home program."*

Typically white pine, our timber frame materials are purchased from suppliers who are members of the Sustainable Forest Initiative. They promote environmentally appropriate, socially beneficial, economically viable management of the world's forests. A timber frame home by it's very nature will outlive many other construction methods.

I-joist subfloor system is manufactured with O.S.B. which is a more environmentally sound choice vs. 2 x12 dimensional lumber. OSB is made from under-utilized strand lumber materials.

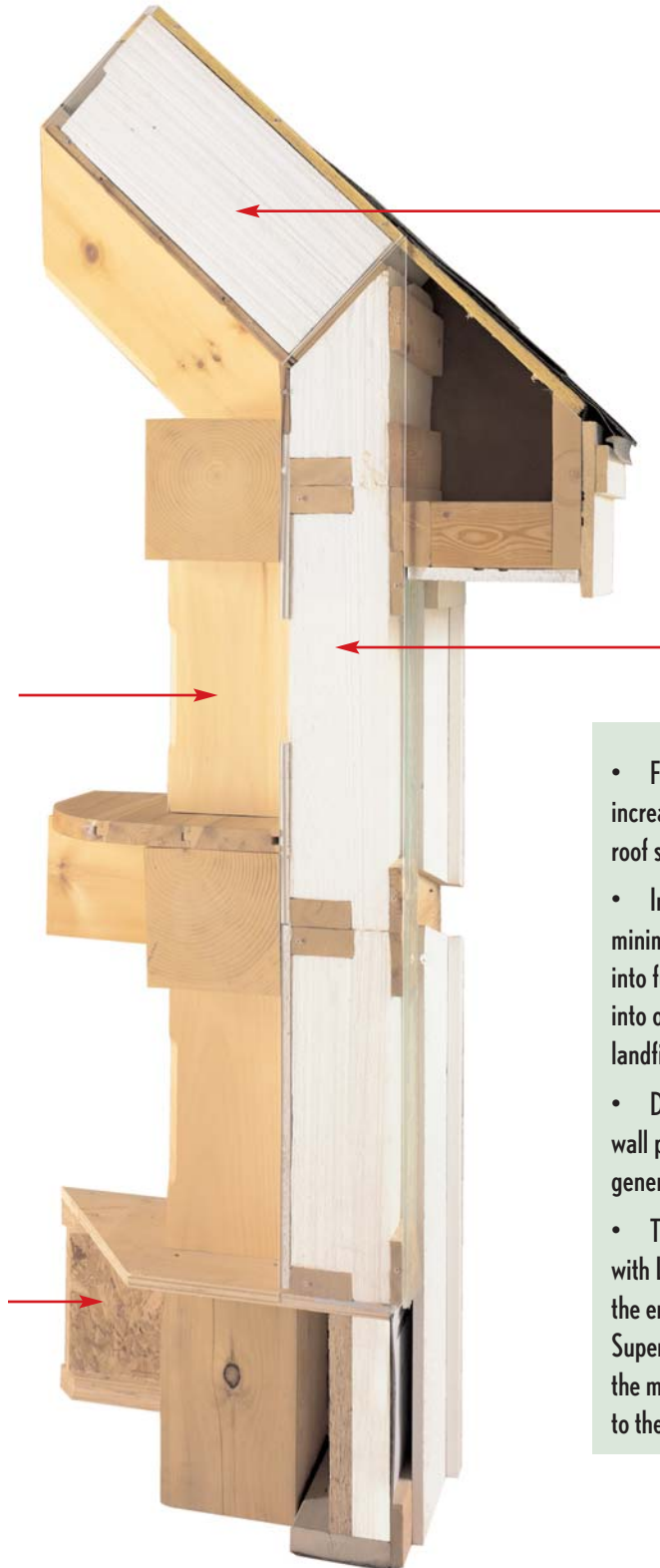

Our R38 EPS roof system and R24 EPS (expanded polystyrene) wall panel, offer a superior R-value compared to typical framing methods. There is no thermal bridging as well there are no harmful CFC's, HCFC's or formaldehyde.

- For even greater efficiency we can increase the R-value in both the wall and roof systems.
- In our manufacturing process any minimal waste that is produced is recycled into future building projects or recycled into other products. It is not sent to a landfill site.
- Due to prefabrication of timber and wall panels, our construction sites generate minimum waste on location.
- The use of highly efficient windows with Low E and argon gas combined with the energy efficiency of the Normerica Super E building system, makes us one of the most energy efficient "Green" suppliers to the building industry.



## NORMERICA®

AUTHENTIC TIMBER FRAME HOMES

Visit us online at: [www.normerica.com/enviro.html](http://www.normerica.com/enviro.html) for further details of Normerica and the Environment.